



These instructions cover the assembly of both the steel and poly PRO-PLOW blades.

# STEEL PRO-PLOW AND POLY PRO-PLOW ASSEMBLY INSTRUCTIONS

Steel PRO-PLOW Blade No. 60381, 60390, 60308, or 60655

Poly PRO-PLOW Blade No. 62400 or 62450

A, Q & L Box No. 63568

Hydraulics Box No. 56365

Headlamp Kit No. 61540 or 61550

Both the steel and poly PRO-PLOW blades use the same 63568 A,Q&L box. A,Q&L follows same assembly for both steel and poly Pro-Plow blades. Poly blade has an additional step to attach rubber deflector. The poly PRO-PLOW blade assemblies include either 62396 or 62381 snow deflector assembly.

## **⚠ CAUTION**

See your WESTERN® outlet for application recommendations. The Selection List has specific vehicle and snowplow requirements.





# TABLE OF CONTENTS

---

<b>SAFETY</b> .....	<b>1</b>
Safety Definitions .....	1
Safety Labels .....	1
Safety Precautions .....	1
Personal Safety .....	2
Fire and Explosion .....	2
Ventilation .....	2
Battery Safety .....	3
Hydraulic Safety .....	3
Torque Chart .....	3
<b>ASSEMBLY INSTRUCTIONS</b> .....	<b>4</b>
Plow Assembly with Steel or Poly PRO-PLOW	
Blade .....	4
Assembling Quadrant to Blade .....	5
Assembling A-Frame to Quadrant .....	5
Assembling Chain Attachment to A-frame .....	6
Assembling Stand to A-frame .....	6
Assembling Lift Frame to A-frame .....	7
Assembling Lift Channel and Hydraulic Unit to Lift Frame .....	8
Assembling Hydraulic Fittings and Hoses .....	8
Assembling Light Brackets and Headlamps .....	9
Hydraulic Unit Wiring Assembly .....	9
Battery Cable to Motor Assembly .....	10
7-1/2' & 8' Poly Blade Snow Deflector Assembly .....	11
Blade Guide Assembly Installation Instructions .....	11

# SAFETY

## SAFETY DEFINITIONS

### **⚠ WARNING**

Indicates a potentially hazardous situation that, if not avoided, could result in death or serious personal injury.

### **⚠ CAUTION**

Indicates a situation that, if not avoided, could result in minor personal injury and/or damage to product or property.

**NOTE:** Identifies tips, helpful hints and maintenance information the owner/operator should know.

## SAFETY LABELS

Become familiar with and inform users about the warning and instruction labels on the back of the blade.

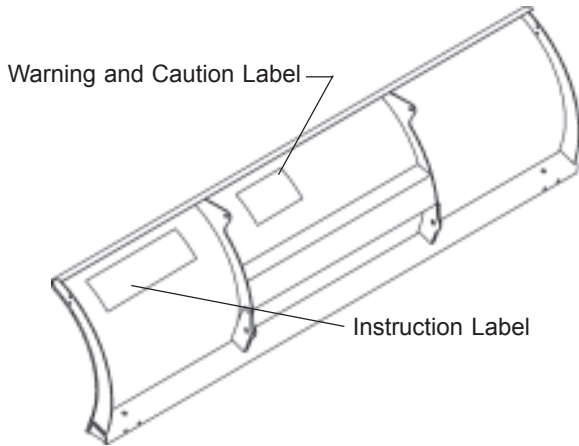

Instruction Label



Warning and Caution Label

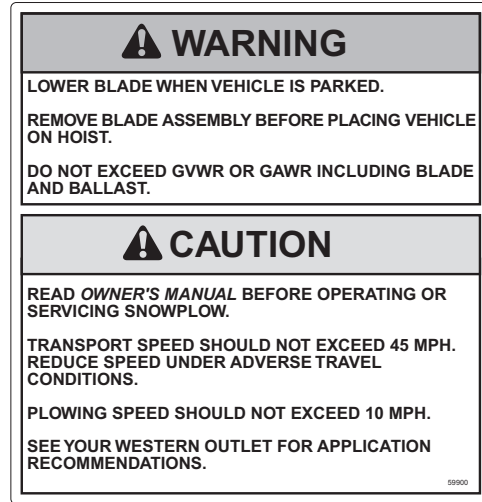

## SAFETY PRECAUTIONS

Improper installation and operation could cause personal injury, and/or equipment and property damage. Read and understand labels and the *Owner's Manual* before installing, operating, or making adjustments.

### **⚠ WARNING**

Lower blade when vehicle is parked. Temperature changes could change hydraulic pressure, causing the blade to drop unexpectedly or damaging hydraulic components. Failure to do this can result in serious personal injury.

### **⚠ WARNING**

Remove blade assembly before placing vehicle on hoist.

### **⚠ WARNING**

Keep well clear of the blade when it is being raised, lowered or angled. Do not stand between the vehicle and blade or directly in front of blade. If the blade hits you or drops on you, you could be seriously injured.

(Continued on next page.)

# SAFETY

## SAFETY PRECAUTIONS (CONTINUED)

### **⚠ WARNING**

The driver shall keep bystanders clear of the blade when it is being raised, lowered or angled. Do not stand between the vehicle and the blade or within 8 feet of a moving blade. A moving or falling blade could cause personal injury.

### **⚠ WARNING**

Keep hands and feet clear of the blade and A-frame when mounting or removing the snowplow. Moving or falling assemblies could cause personal injury.

### **⚠ WARNING**

Do not exceed GVWR or GAWR including blade and ballast. The rating label is found on driver-side vehicle door cornerpost.

### **⚠ CAUTION**

Refer to the current selection list for minimum vehicle recommendations and ballast requirements.

### **⚠ CAUTION**

To prevent accidental movement of the blade, always turn the ON/OFF switch to OFF whenever the snowplow is not in use. The control indicator light will turn off.

## PERSONAL SAFETY

- Wear only snug-fitting clothing while working on your vehicle or snowplow.
- Do not wear jewelry or a necktie, and secure long hair.
- Wear safety goggles to protect your eyes from battery acid, gasoline, dirt and dust.
- Avoid touching hot surfaces such as the engine, radiator, hoses and exhaust pipes.
- Always have a fire extinguisher rated BC handy, for flammable liquids and electrical fires.

## FIRE AND EXPLOSION

### **⚠ WARNING**

Gasoline is highly flammable and gasoline vapor is explosive. Never smoke while working on vehicle. Keep all open flames away from gasoline tank and lines. Wipe up any spilled gasoline immediately.

Be careful when using gasoline. Do not use gasoline to clean parts. Store only in approved containers away from sources of heat or flame.

## VENTILATION

### **⚠ WARNING**

Vehicle exhaust contains deadly carbon monoxide (CO) gas. Breathing this gas, even in low concentrations, could cause death. Never operate a vehicle in an enclosed area without venting exhaust to the outside.

# SAFETY

## BATTERY SAFETY

### ⚠ CAUTION

Batteries normally produce explosive gases which can cause personal injury. Therefore, do not allow flames, sparks or lit tobacco to come near the battery. When charging or working near a battery, always cover your face and protect your eyes, and also provide ventilation.

Batteries contain sulfuric acid which burns skin, eyes and clothing.

Disconnect the battery before removing or replacing any electrical components.

### ⚠ CAUTION

Always disconnect the battery before removing or replacing electrical components such as a motor relay or battery cable.

## HYDRAULIC SAFETY

### ⚠ WARNING

Hydraulic oil under pressure could cause skin injection injury. If you are injured by hydraulic oil, get medical attention immediately.

### ⚠ CAUTION



Do not mix different types of hydraulic fluid. Some fluids are not compatible and may cause performance problems and product damage.

- Always inspect hydraulic components and hoses before using. Replace any damaged or worn parts immediately.
- If you suspect a hose leak, DO NOT use your hand to locate it. Use a piece of cardboard or wood.

## TORQUE CHART

### ⚠ CAUTION

Read instructions before assembling. Bolts should be finger tight until instructed to tighten according to the torque chart. Use standard methods and practices when attaching snowplow including wearing safety glasses during cutting, drilling and welding.

<b>Recommended Fastener Torque Chart (Ft.-Lb.)</b>			
Size	 SAE Grade 2	 SAE Grade 5	 SAE Grade 8
1/4-20	6	9	13
5/16-18	11	18	28
3/8-16	19	31	46
3/8-24	24	46	68
7/16-14	30	50	75
1/2-13	45	75	115
9/16-12	66	110	165
5/8-11	93	150	225
3/4-10	150	250	370
7/8-9	202	378	591
1-8	300	583	893
<b>Metric Grade 8.8 (Ft.-Lb.)</b>			
Size	Torque	Size	Torque
M 6	7	M 12	60
M 8	17	M 14	95
M 10	35	M 16	155
These torque values apply to mount assembly fasteners except those noted in the instruction.			

# ASSEMBLY INSTRUCTIONS

## PLOW ASSEMBLY WITH STEEL OR POLY PRO-PLOW BLADE

### ⚠ WARNING

To avoid personal injury, follow steps in sequence.

### ⚠ CAUTION

See your WESTERN® outlet for application recommendations.

**IMPORTANT:** Read instructions before assembling. Bolts should be finger tight until instructed to tighten. Use standard methods and practices when attaching the snowplow.

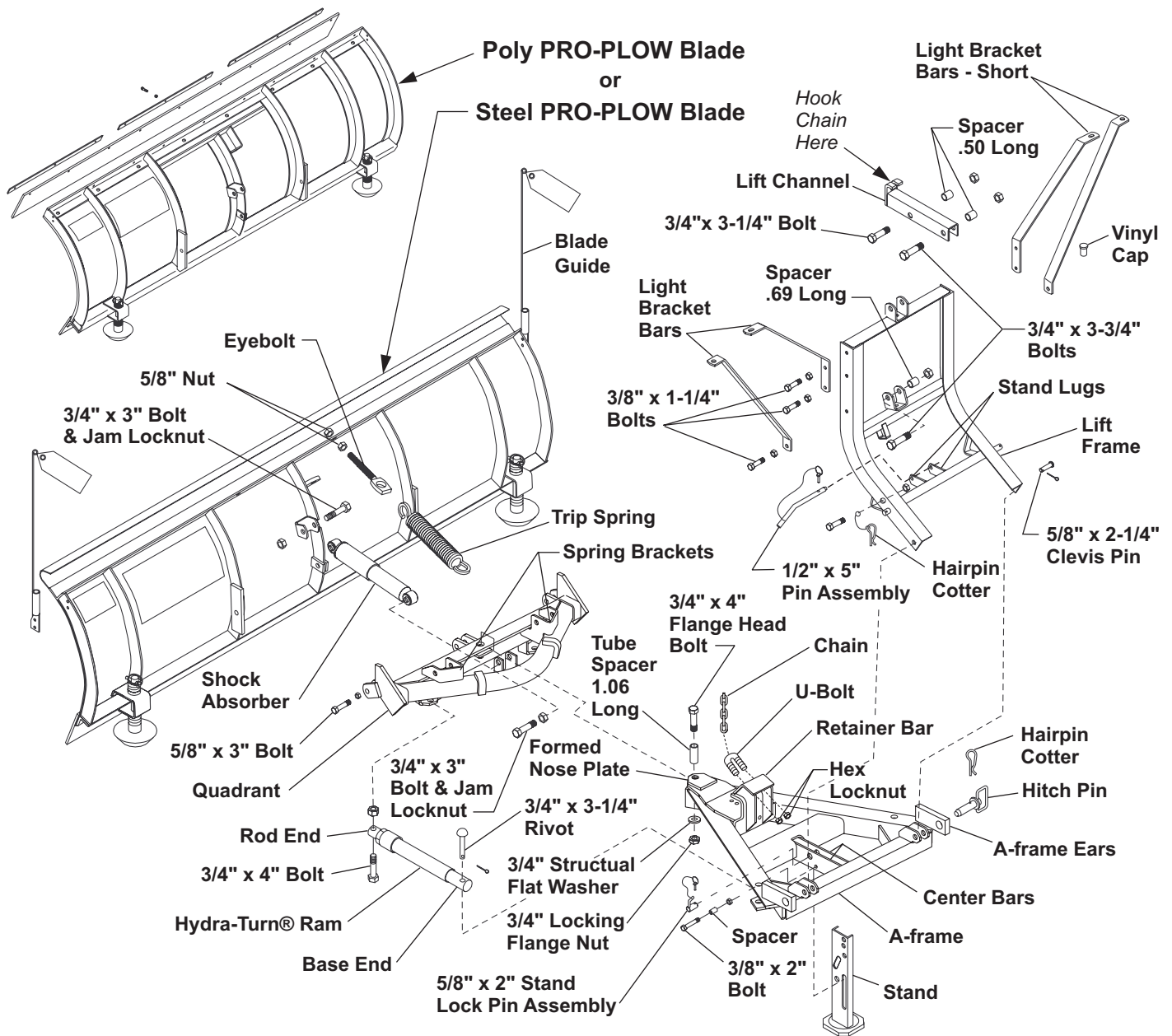

Figure 1

# ASSEMBLY INSTRUCTIONS

## Assembling Quadrant to Blade

1. Lay the blade face down on cardboard on the floor. Assemble the quadrant to the blade with the center pair of quadrant lugs straddling the blade center rib. Secure with three 5/8" x 3" bolts and locknuts. **DO NOT overtighten the nuts as it may bend the lugs.**
2. Thread one 5/8" nut halfway down on each of four eyebolts. Hook a spring to each of the quadrant brackets indicated in the preceding diagram (see **Figure 1**). Hook an eyebolt to the other end of each trip spring.

Push the threaded ends of the eyebolts through the four holes in the top angle of the blade. Install a second nut on each eyebolt.

### ⚠ CAUTION

Servicing the trip springs without special tools and knowledge could result in personal injury. See your authorized WESTERN® outlet for service.

### ⚠ CAUTION

Over tightening springs will not increase blade trip force and can damage the springs.

Tighten the top nuts until the coils of the trip springs begin to separate (a piece of paper such as this instruction sheet should pass between the second and third coils). Tighten the bottom nut against the blade angle or lug to lock in place.

3. Position large shield end of the shock absorber into the U-bracket on the blade center rib. Secure with a 3/4" x 3" bolt installed from the rib side of the U-bracket and jam locknut. Place other end of shock absorber into lugs on formed tube of quadrant and secure with a 3/4" x 3" bolt and jam locknut. Tighten both bolts.

## Assembling A-frame To Quadrant

1. Insert the A-frame formed nose plate between the quadrant straight angle and quadrant tab, and at the same time, hook the A-frame retainer bar over the formed tube of the quadrant.
2. Install a 3/4" x 4" flange head bolt (pivot bolt) through 1.06 long spacer, from the top through the holes in the quadrant top plate, nose plate, quadrant angle, and A-frame angle. (See **Figure 2**.)

**IMPORTANT: Bolt must be installed from Top Down**

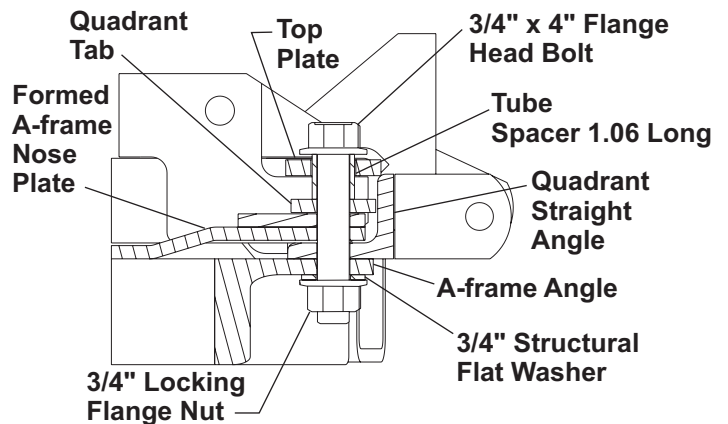

**Figure 2**

3. Coat pivot surfaces, flanges of bolt, nut and washers with antisieze compound.
4. Install a flat washer and 3/4" flange locknut onto the bolt and tighten as follows:
  - A. Tighten pivot bolt until the A-frame will NOT move.
  - B. Loosen pivot bolt 1/4 turn at a time until A-frame moves (A-frame should move but not be loose).
5. Position the rod ends of the two Hydra-Turn® rams (found in hydraulics box) to the brackets on the bottom of the straight angle of the quadrant. Secure the rod end of each ram to the quadrant with a 3/4" x 4" bolt (installed from the bottom upward) and a locknut.

(Continued on next page.)



# ASSEMBLY INSTRUCTIONS

## Assembling A-frame To Quadrant (Continued)

6. Swing the A-frame to one side. Making sure the threaded port is facing away from the A-frame, position the base end of a Hydra-Turn® ram into the bracket on the side of the A-frame. Insert a 3/4" x 3-1/2" rivet from the top down and secure with a cotter pin. Remove the pipe plug from the threaded port.
7. Swing the A-frame to the other side and repeat Step 6 to connect the other ram to the A-frame.

## Assembling Chain Attachment To A-frame

1. Insert the 3/8" x 1-1/2" U-bolt through the end link of the chain.
2. Insert the ends of the U-bolt into the holes in the nose plate of the A-frame and secure with locknuts.

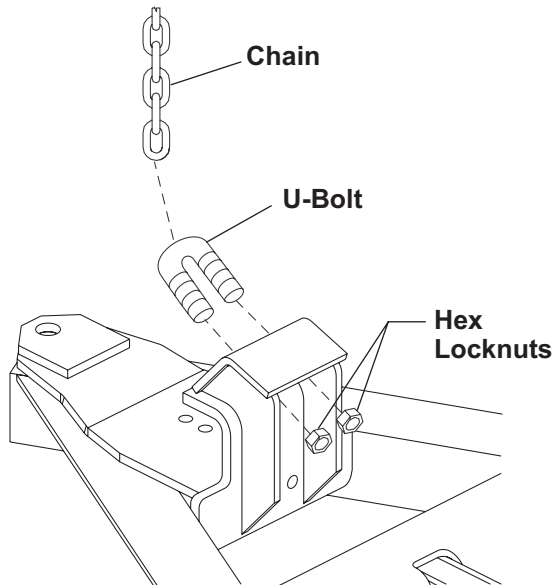

Figure 2

## Assembling Stand To A-frame

If stand is already installed, proceed to Step 5 of this section.

1. Position the stand next to the center bars of the A-frame with the long slot towards the wide end of A-frame.
2. Insert the 9/16" OD spacer into the top end of the long slot in the stand.
3. Holding spacer in place with a finger, insert the stand between the A-frame center bars and align spacer with small hole in center bars.
4. Secure spacer with a 3/8" x 2" bolt and locknut.
5. Hold stand perpendicular to A-frame. Align short slot in stand with large hole in center bars, and insert the 5/8" x 2" stand lock pin assembly. Secure stand lock pin with a 3/16" linchpin.
6. Tip the plow assembly into plowing position.

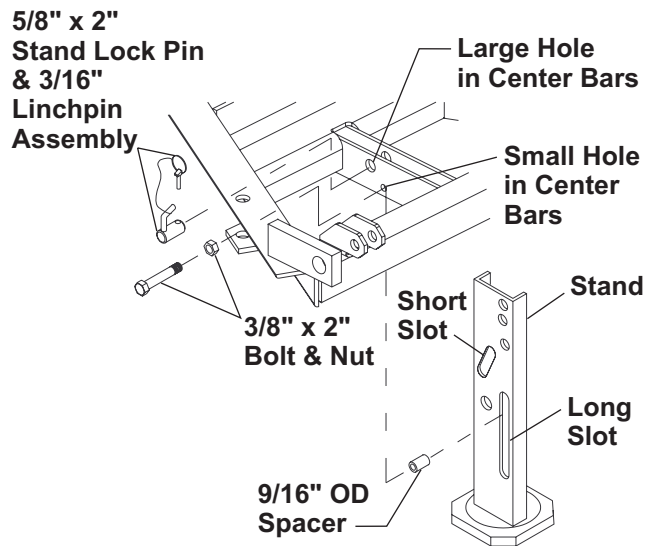

Figure 3

# ASSEMBLY INSTRUCTIONS

## Assembling Lift Frame To A-frame

1. Lay lift frame on floor with curve up and ends of side angles positioned next to wide end of A-frame. Raise end of lift frame and align holes in side angles between inner pairs of lugs on wide end of A-frame.
2. Secure lift frame to A-frame lugs with two 5/8" x 2-1/4" clevis pins inserted from the outside towards the center of the A-frame. Secure with cotter pins.

### **⚠ CAUTION**

**Never use a finger to check an alignment. If the snowplow moves, your finger could be crushed.**

3. Rotate lift frame to align holes in stand lugs to bottom hole of three hole pattern in top of stand. Secure with a 1/2" x 5" stand pin and 3/16" linchpin assembly.
4. Assemble a hairpin cotter through one eyelet of the 6" lanyard. Attach the other end to the hole in the lift frame located above the stacking stop bracket using the 1/4" flange bolt and nut.

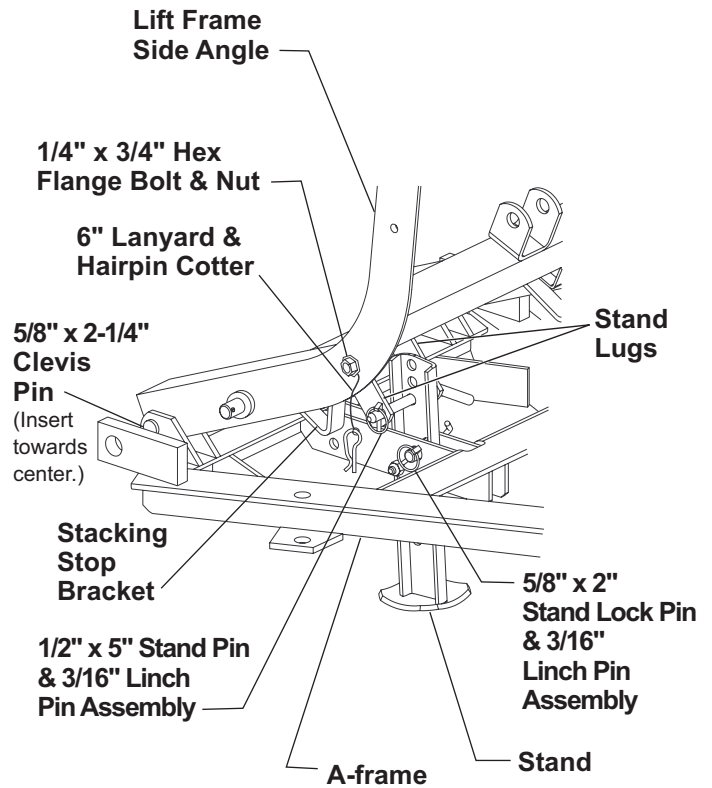

**Figure 4**  
**Lift Frame Pinned to A-frame and Stand**

# ASSEMBLY INSTRUCTIONS

## Assembling Lift Channel and Hydraulic Unit To Lift Frame

1. Place the hole end of the lift channel between the lugs of the upper U-bracket on the lift frame. Insert a 3/4" x 3-3/4" bolt and secure with a .50 long spacer and a locknut. **DO NOT OVERTIGHTEN** - lift channel must pivot freely.
2. Position the hydraulic unit (found in hydraulics box), with the nameplate towards the blade, and with the base lug between the lugs of the lower U-bracket on the lift frame. Attach with a 3/4" x 3-3/4" bolt, a .69 long spacer, and a locknut. **DO NOT OVERTIGHTEN** - hydraulic unit must pivot freely.
3. Align hole in hydraulic unit lift ram with hole near hook on lift channel and attach with a 3/4" x 3-1/4" bolt, a .50 long spacer, and a locknut. **DO NOT OVERTIGHTEN** - lift channel must pivot freely.
4. Place second link of chain into hook of lift channel. (Final chain adjustment will be made after plow is mounted on vehicle.)

## Assembling Hydraulic Fittings and Hoses

1. (Hoses and fittings are in the hydraulics box.) Remove top two 1/4" pipe plugs from front face of valve on hydraulic unit. Install two 45° swivel fittings into pipe plug holes. Tighten fittings so the hose connections will be straight down in line with valve body. **(See Figure 5.)**
2. Install a 1/4" street elbow into the threaded port in base end of each Hydra-Turn® ram. Tighten fittings so they are oriented 45° from vertical towards the blade. **(See Figure 5.)**
3. Install a hose into the street elbow on each Hydra-Turn ram. Tighten each hose.
4. Route both hoses in front of lift frame and from passenger side to driver side through hose loop on middle cross angle of lift frame.
5. Attach hoses to 45° swivel fitting on hydraulic unit as follows:
  - Passenger side hose to rear 45° swivel fitting.
  - Driver side hose to front 45° swivel fitting.Remove twists from both hoses and tighten swivel connections.

DO NOT use pipe tape/sealant when connecting hoses to swivel fittings.

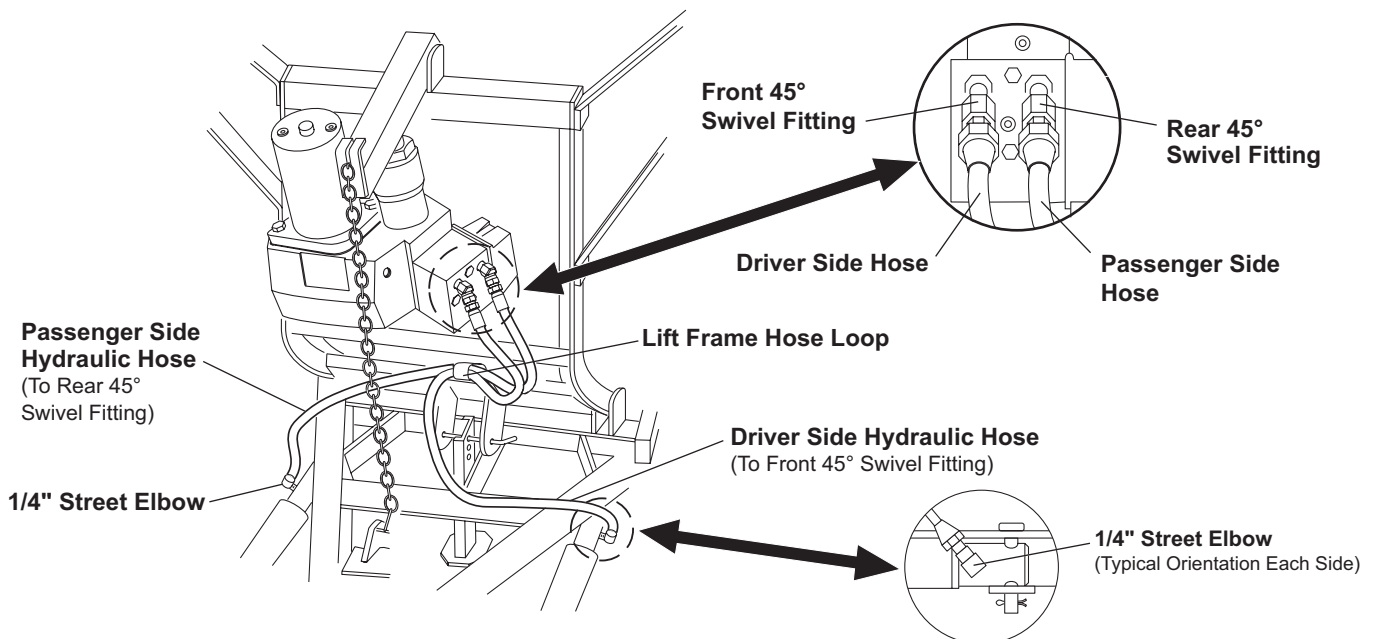

**Figure 5**  
**Hydraulic Fitting Orientation and Hose Routing**

# ASSEMBLY INSTRUCTIONS

## Assembling Light Brackets and Headlamps

1. Align two holes of two top light brackets with the top two holes in lift frame side angles. Loosely attach with two 3/8" x 1-1/4" bolts and locknuts on each side.
2. Loosely attach the small hole end of each bottom light bracket to the lowest hole in each lift frame side angle with a 3/8" x 1-1/4" bolt and locknut on each side.

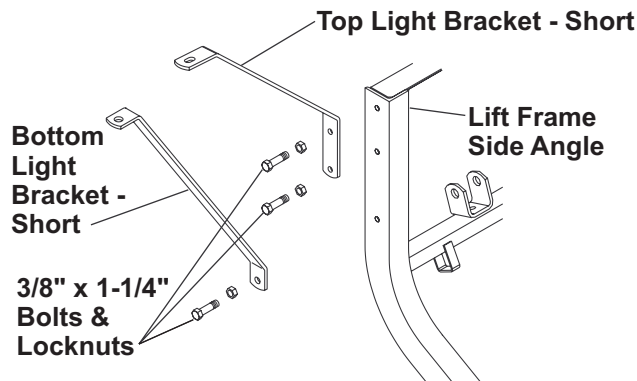

Figure 6

3. Assemble headlamps (found in headlamp kit) to the light brackets, placing the headlamp swivel above the bracket. Loosely attach with lock washers and nuts below the brackets. Aim headlamps when plow is attached to vehicle.

4. Tighten bolts holding light brackets to lift frame.
5. Install vinyl caps on headlamp mounting studs.

## Hydraulic Unit Wiring Assembly

1. Route wiring harness from headlamps along top light brackets and across back of lift frame to driver side of lift frame. Use any excess harness to make a loop under each headlamp. Secure harness to each light bracket with two short cable ties, and to top angle of lift frame with a long cable tie.
2. Remove cover from valve manifold on hydraulic unit. Route branch of harness with loose wires to manifold. Apply dielectric grease (P.N. 56099, furnished in hydraulics box) into the opening of each wire terminal before connecting to coil terminals as shown on label inside of cover.

**NOTE: Dielectric grease has been applied to coil terminals. DO NOT wipe off terminals.**

3. With harness strain relief inside cover at slot and black/orange wire outside of cover, replace cover and secure with screws.
4. While allowing slack in harness to hydraulic unit, secure harness to inside of lift frame side rail with two long cable ties.

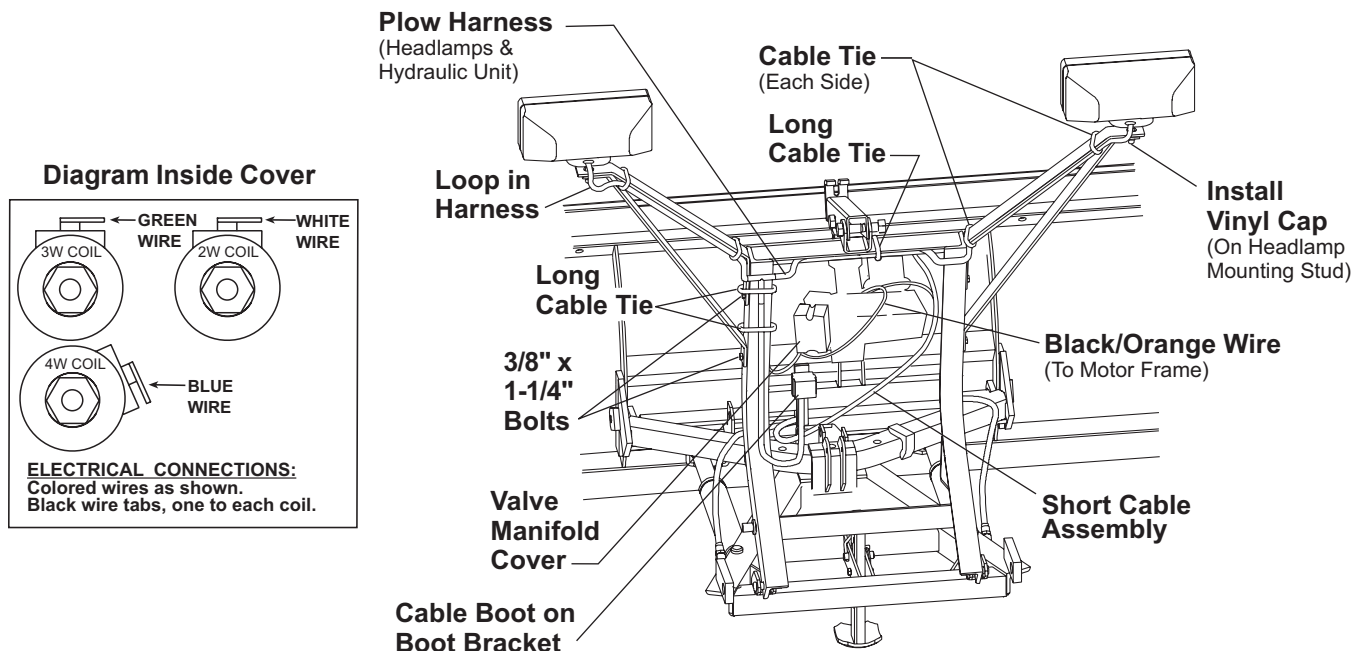

Figure 7

# ASSEMBLY INSTRUCTIONS

## Battery Cable To Motor Assembly

Apply a light coating of dielectric grease to connectors before assembly.

**NOTE: Retain dielectric grease tube for use during vehicle mount installation. Pass tube on to end user.**

All parts installed in this section are found in the hydraulics box.

1. Attach black/red battery cable to motor terminal on hydraulic unit. Secure nut to 50-60 in. lbs.
2. Attach black battery cable (without a stripe) and the black/orange wire from under the valve manifold cover to the ground stud. Secure nut to 50-60 in. lbs.

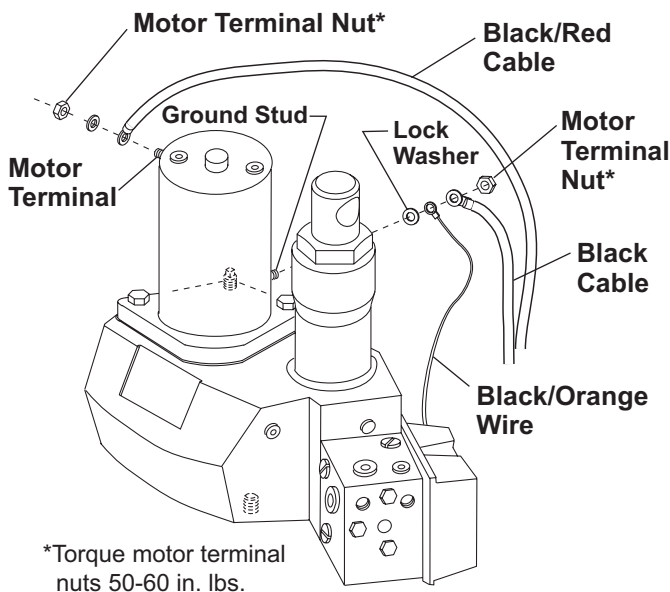

**Figure 8**

3. Slide small pocket of cable boot onto vertical tab of boot bracket. Insert harness plugs into boot for storage when plow is removed from vehicle.

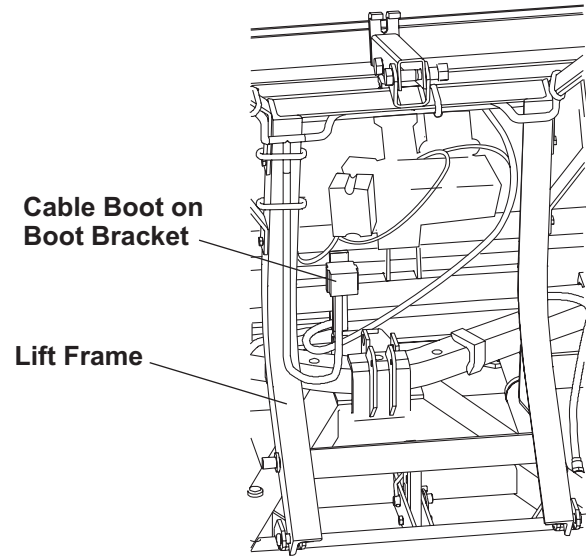

**Figure 9**

# ASSEMBLY INSTRUCTIONS

## 7-1/2' AND 8' POLY BLADE SNOW DEFLECTOR ASSEMBLY

Align the holes in the rubber deflector material with the holes in the poly blade frame top angle. Starting at one end, align end hole in retainer bar with end hole in deflector and blade frame top angle. Loosely install 5/16" x 1-1/4" cap screws and locknuts in retainer bar holes. Position remaining retainer bars and install fasteners. Tighten bolts starting from the center of the blade towards each end.

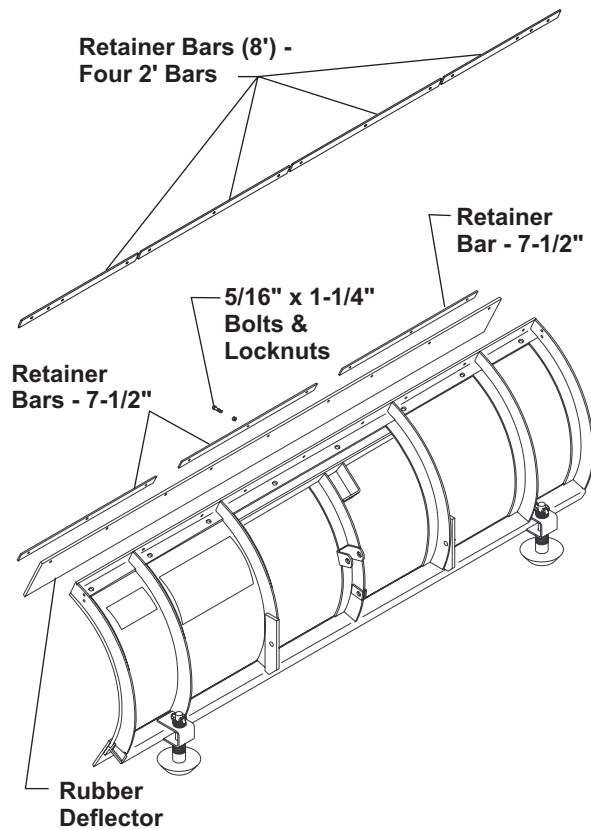

Figure 10

## BLADE GUIDE ASSEMBLY INSTALLATION INSTRUCTIONS

Insert pointed end of clamp into coil of the blade guide rod. Attach a blade guide rod to each outer rib using 5/16" x 1" cap screws and locknuts as shown in Figure 11.

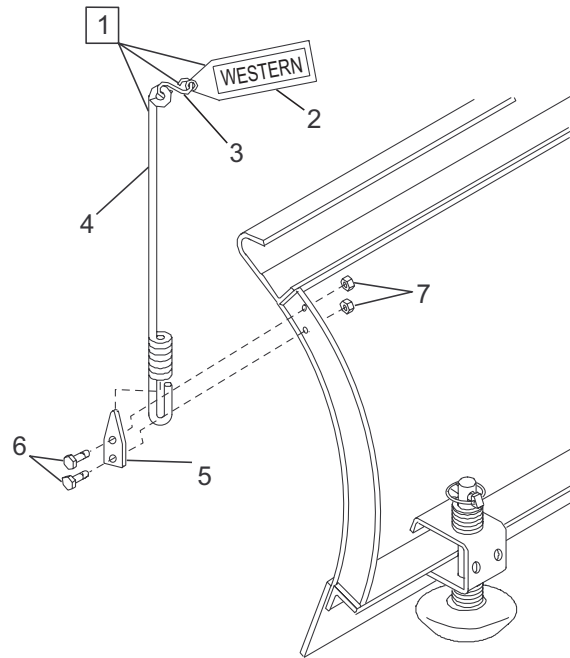

Figure 11

### PARTS LIST 59700 — BLADE GUIDE ASSEMBLY

ITEM	PART NO.	QTY.	DESCRIPTION
1	59697	2	BLADE GUIDE ROD, S-HOOK & FLAG
2	. 59694K	1	BLADE GUIDE FLAG
3	. 59696	1	S-HOOK
4	. 59691	1	BLADE GUIDE ROD
5	59946	2	CLAMP
6	90020	4	5/16-18X1 HX CS G2 ZP
7	91332	4	5/16-18 PT HX LK NUT NYIS ZP

#### Abbreviations

CS	Cap Screw
G	Grade
HX	Hex
LK	Lock
NYIS	Nylon Insert
PT	Prevailing Torque
ZP	Zinc Plate





WESTERN PRODUCTS  
P.O. BOX 245038  
MILWAUKEE, WI 53224-9538



A DIVISION OF DOUGLAS DYNAMICS, L.L.C.

Western Products reserves the right under its Product Improvement Policy to change construction or design details and furnish equipment when so altered without reference to illustrations or specifications used herein. Western Products and the vehicle manufacturer may require and/or recommend optional equipment for snow removal. Western Products offers a limited warranty on the snowplows and accessories. See separately printed page for this important information. The following are registered® trademarks of Douglas Dynamics, L.L.C.: HYDRATURN®, UNIMOUNT®, and WESTERN®.